



DRUID E & DREADNOUGHT E EXPLODED VIEWS

EXPLODED VIEWS

SEATSTAY & CHAINSTAY

ITEM NO.	PART NO.	DESCRIPTION	QTY
1	-	CHAINSTAY	1
2	004.002.0026	V3 CHAINSTAY PROTECTOR	1
3	004.002.0027	V3 SEATSTAY PROTECTOR	1
4	-	SEATSTAY	1
5	002.001.0011	SHAFT 12x30	2
6	004.001.0014	CABLE PORT SINGLE ALTERNATIVE SIDE	1
7	003.007.0002	M5x16 ACCESSORY SCREW 4mm HEX	2
8	005.001.0006	ENDURO 6903 LLU MAX BO	2
9	002.004.0022	SPACER SLEEVE 17x49.5	1
10	002.004.0014	SHIELD SPACER 17x2.25	2
11	005.001.0009	ENDURO 6901 LLU MAX BO	4
12	002.004.0016	SPACER 12x1.5	2
13	002.004.0020	SPACER 12x3	4
14	004.001.0012	CABLE PORT TRIPLE	1

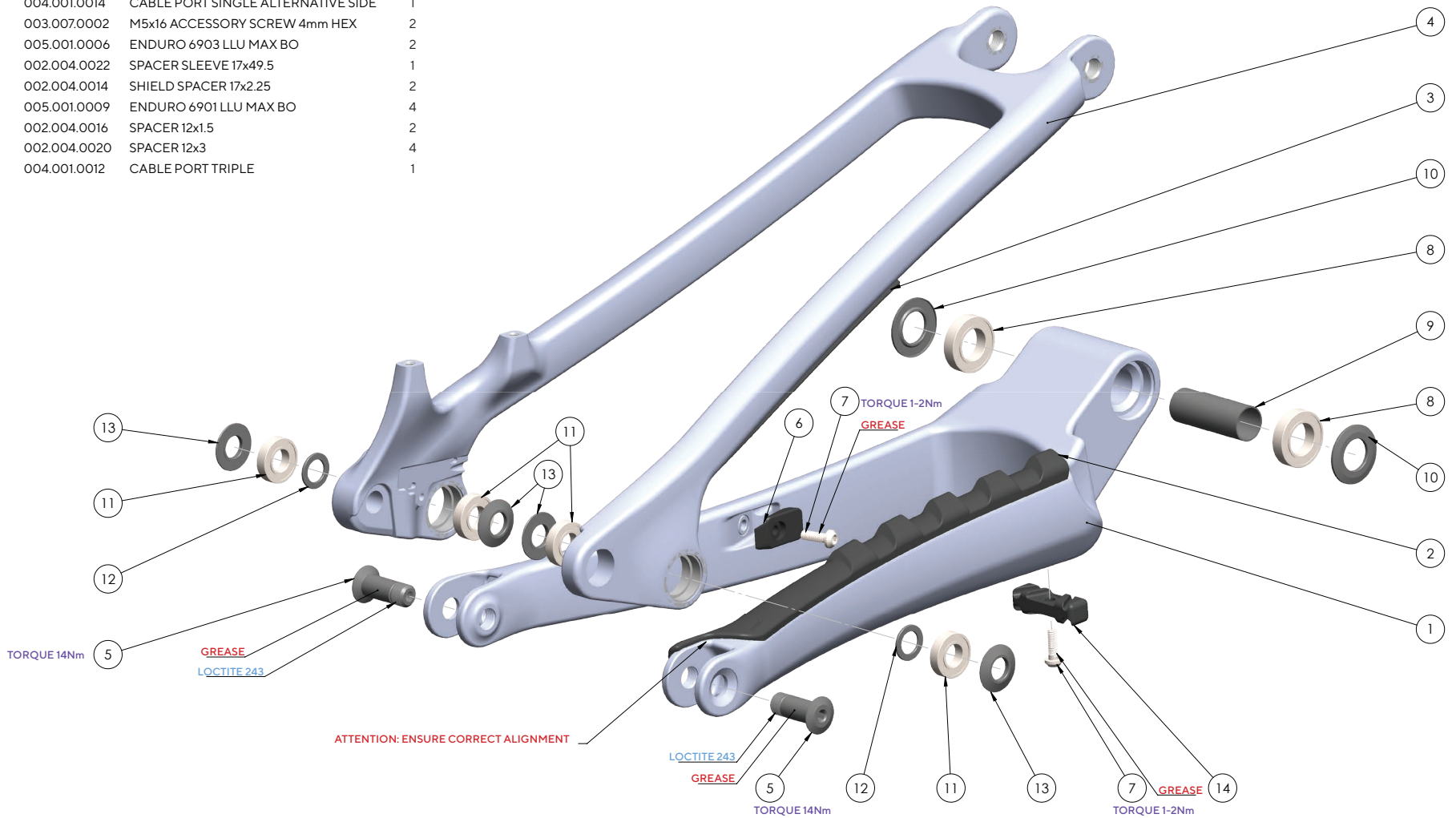

EXPLODED VIEWS

FRONT TRIANGLE

ITEM NO.	PART NO.	DESCRIPTION	QTY
15	003.006.0001	SEAT CLAMP	1
16	003.007.0008	SEAT CLAMP BARREL	1
17	003.007.0005	SEAT CLAMP SCREW	1

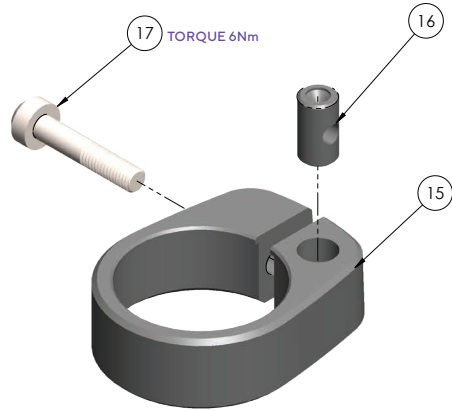

ITEM NO.	PART NO.	DESCRIPTION	QTY
7	003.007.0002	M5x16 ACCESSORY SCREW 4mm HEX	7
18	-	FRONT TRIANGLE	1
19	004.002.0033	V3 FENDER	1
20	004.001.0003	CABLE PORT SINGLE	2
21	003.999.0002	SEAT CLAMP ASSEMBLY	1
22	002.004.0018	SPACER SLEEVE 17x31.5	1
23	005.001.0006	ENDURO 6903 LLU MAX BO	2
24	005.001.0010	ENDURO 6903 LLU SOLID LUBE	2
25	002.004.0014	SHIELD SPACER 17x2.25	2
26	003.001.0024	IDLER PULLEY SCREW [DOUBLE BEARING] - 10x1	1
27	003.001.0023	IDLER PULLEY 18T [DOUBLE BEARING]	1
28	002.004.0021	SPACER 17x1.5	1
29	003.007.0025	M5x8 SHORT ACCESSORY SCREW	2
30	004.001.0013	CABLE PORT QUAD [2x5mm 2x3mm]	1

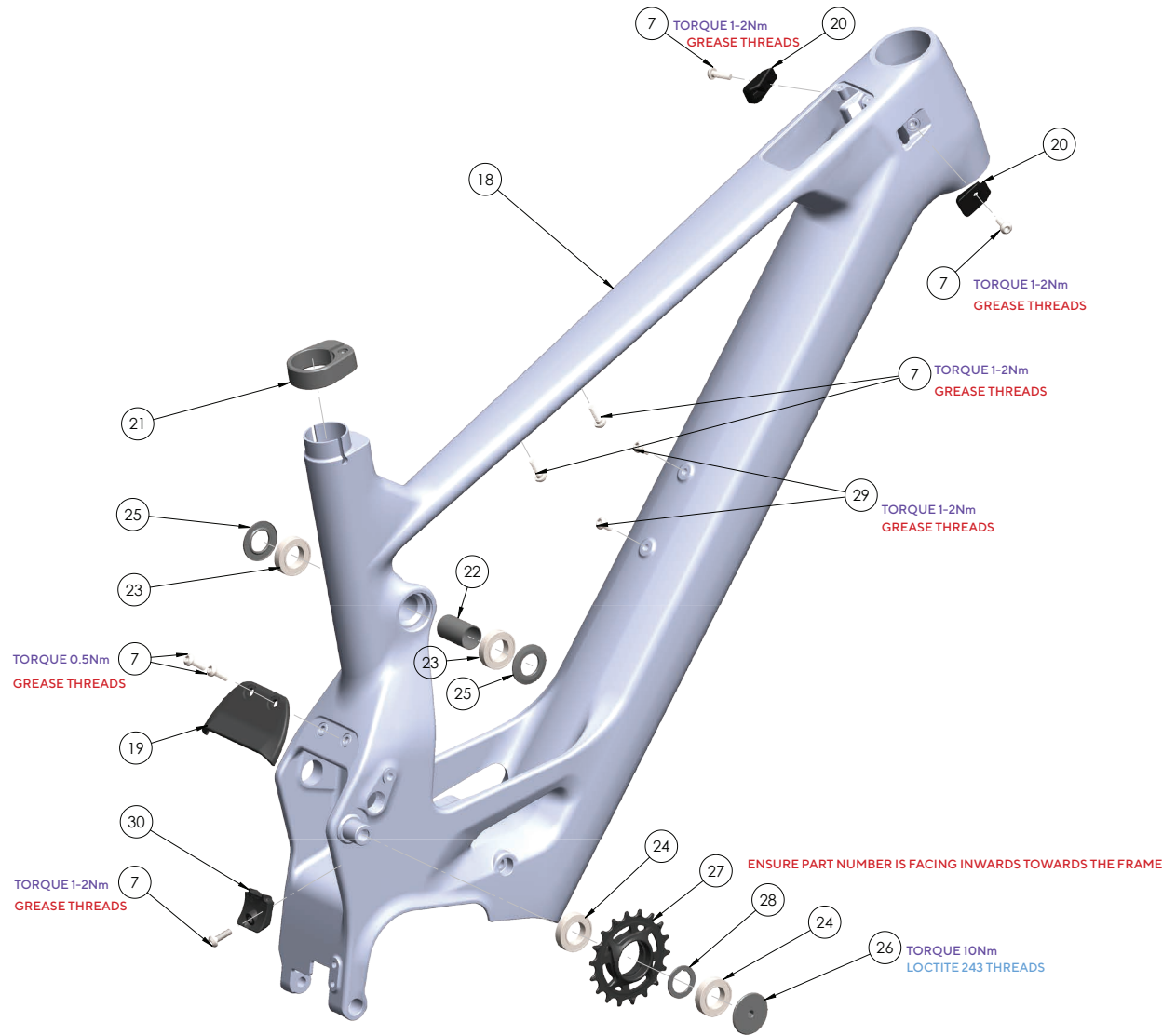

ATTENTION: APPLY LIGHT FILM OF GREASE TO BEARING BORES BEFORE INSTALLATION

EXPLODED VIEWS

ROCKER LINK & MAIN PIVOT

ITEM NO.	PART NO.	DESCRIPTION	QTY
11	005.001.0009	ENDURO 6901 LLU MAX BO	2
31	-	ROCKER LINK	1
32	002.004.0010	SPACER 10x4 FLANGED TOP HAT	2
33	002.002.0006	SCREW 10x1x18.5 24mm OD	2
34	002.001.0020	SHAFT 17x66 EXT	1
35	003.007.0022	M6x20 TAPER SOCKET SCREW 5mm HEX	2
36	002.005.0003	M6x1.6 WASHER 11mm OD	2
37	002.005.0001	TAPERED WASHER 17mm	2
38	002.001.0021	SHAFT 17x50 EXT	1

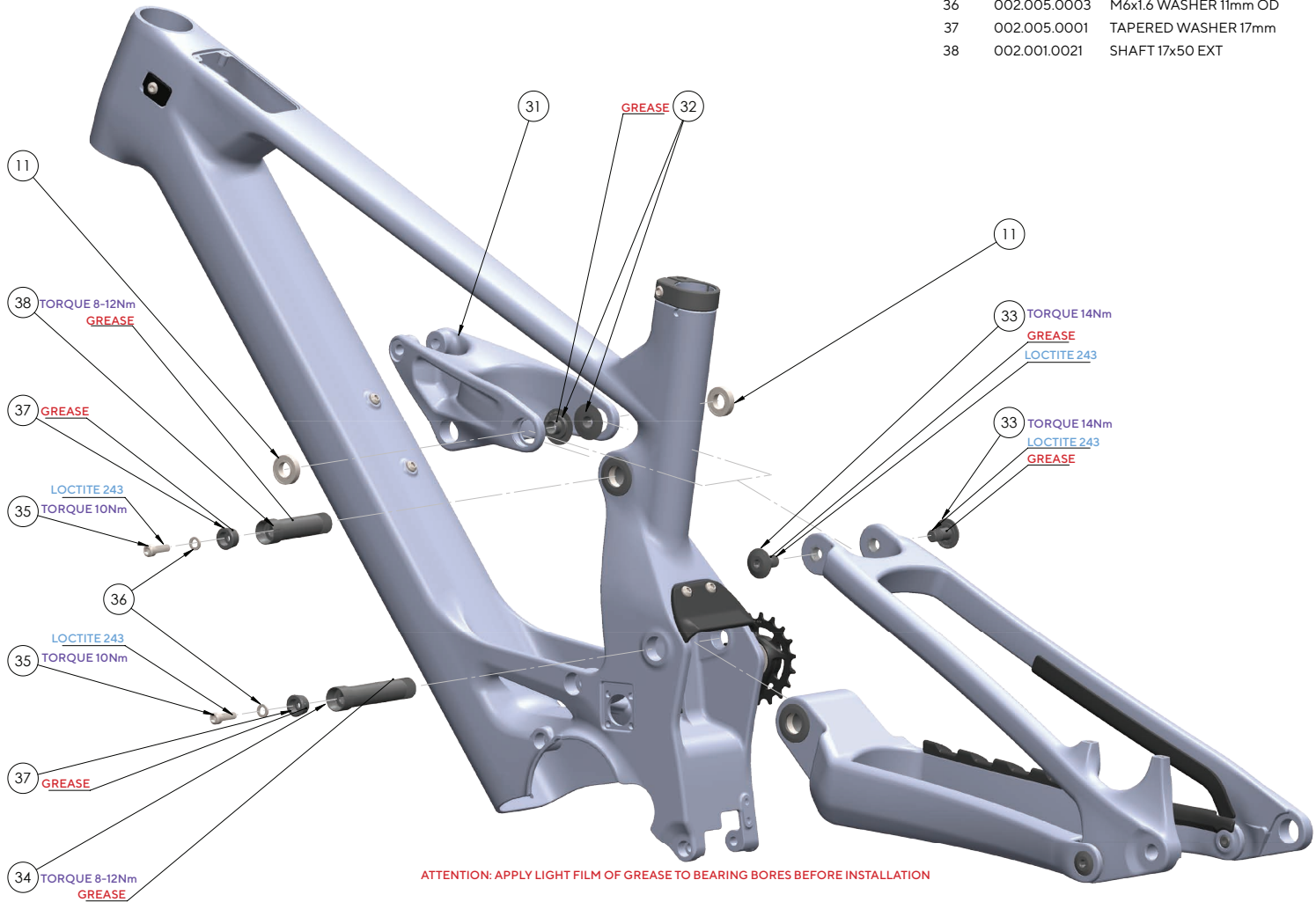

ATTENTION: APPLY LIGHT FILM OF GREASE TO BEARING BORES BEFORE INSTALLATION

EXPLODED VIEWS

DOWNTUBE PROTECTION, CHAINGUIDE & SHOCK

ITEM NO.	PART NO.	DESCRIPTION	QTY
35	003.007.0022	M6x20 TAPER SOCKET SCREW 5mm HEX	1
39	004.002.0030	E-MTB LOWER DOWNTUBE GUARD	1
40	004.002.0032	SHUTTLE GUARD	1
41	004.002.0031	SHUTTLE GUARD & BUMP STOP	-
42	004.003.0010	V2 RACE GUIDE	1
43	003.007.0014	M5x16 - LEFT HAND THREAD SCREW 3mm HEX	1
44	003.007.0032	SHOCK SCREW M8x1.25x58	2

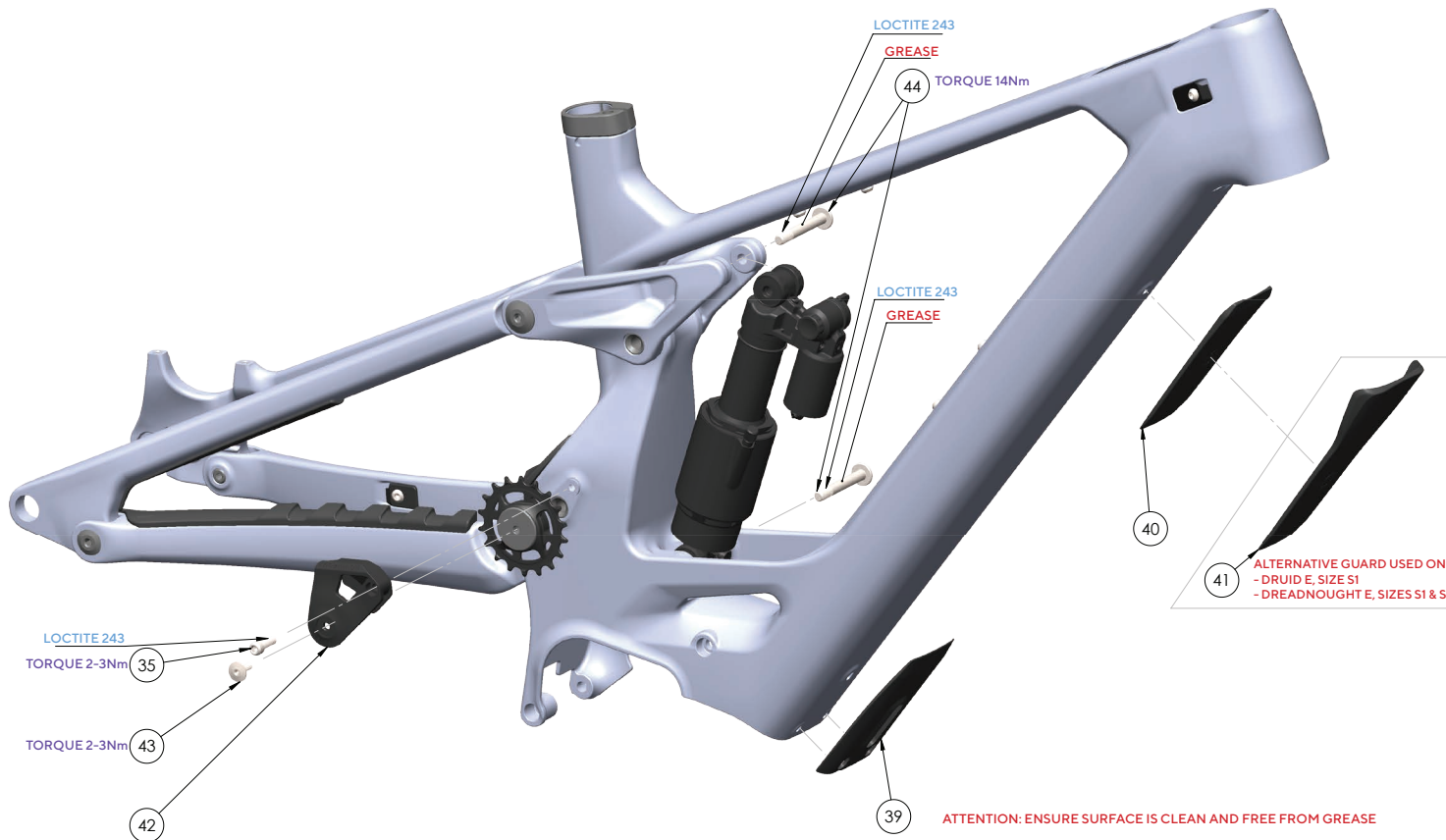
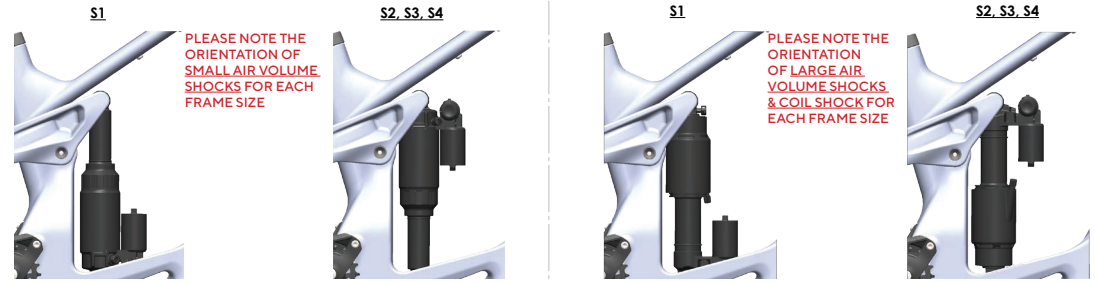

ALTERNATIVE GUARD USED ON:
 - DRUID E, SIZE S1
 - DREADNOUGHT E, SIZES S1 & S2

CABLE ROUTING

OVERVIEW

ITEM NO.	PART NO.	DESCRIPTION	QTY
45	004.002.0037	SPEED SENSOR HOLDER	1
46	003.007.0012	M4x10 SOCKET SCREW 4mm HEX	1
47	-	M3 AVINOX SPEED SENSOR SCREW 2mm HEX	1

ATTENTION: FOR FULL DETAILS ON HOW TO ROUTE EACH CABLE/HOSE PLEASE SEE THE NEXT PAGE



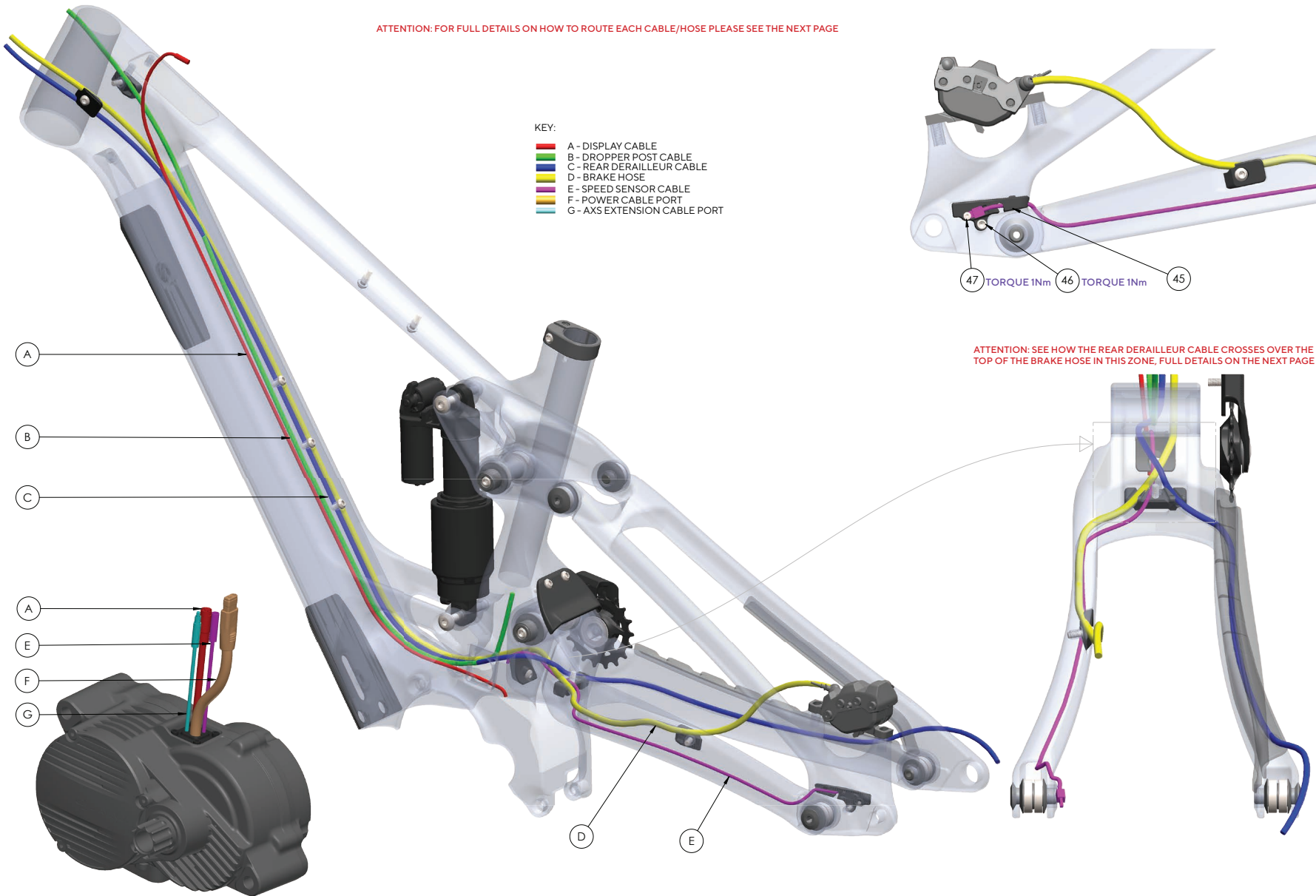

- KEY:
- A - DISPLAY CABLE
 - B - DROPPER POST CABLE
 - C - REAR DERAILLEUR CABLE
 - D - BRAKE HOSE
 - E - SPEED SENSOR CABLE
 - F - POWER CABLE PORT
 - G - AXS EXTENSION CABLE PORT



CABLE ROUTING

DETAILED VIEW

KEY

-  A - DISPLAY CABLE
-  B - DROPPER POST CABLE
-  C - REAR DERAILLEUR CABLE
-  D - BRAKE HOSE
-  E - SPEED SENSOR CABLE

STEP 1: A - DISPLAY CABLE

STARTING FROM THE DISPLAY PORT IN THE TOP TUBE, ROUTE THE CABLE ALONG THE TOP OF THE DOWNTUBE.

STEP 2: B - DROPPER POST CABLE

ROUTE THROUGH THE RIGHT-HAND HEAD TUBE CABLE PORT. ROUTE THE CABLE ALONG THE TOP OF THE DOWNTUBE. WITH THE MOTOR REMOVED, ROUTE CABLE UP THE SEAT TUBE.



STEP 3: C, D & E - REAR DERAILLEUR CABLE, BRAKE HOSE & SPEED SENSOR CABLE

3.1:

REMOVE THE SHOCK AND CYCLE THE SUSPENSION TO FULL COMPRESSION (BOTTOMED OUT). USE A STRAP TO HOLD IT IN THIS POSITION. THIS WILL PROVIDE BETTER ACCESS TO THE UNDERSIDE OF THE MAIN PIVOT AREA. IT ALSO HELPS TO ROTATE THE FRAME IN THE BIKE STAND SO THAT THE MAIN PIVOT AREA IS AT HEAD HEIGHT TO WORK ON.

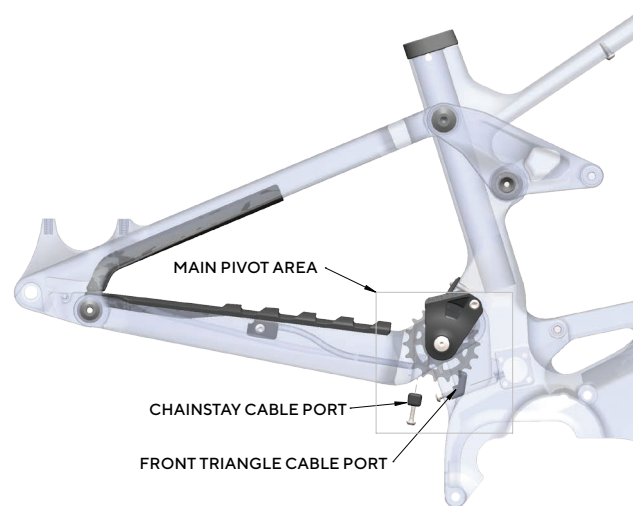

3.2:

REMOVE THE CABLE PORT CLAMPS FROM THE CHAINSTAY AND THE FRONT TRIANGLE IN THE MAIN PIVOT AREA.

3.3:



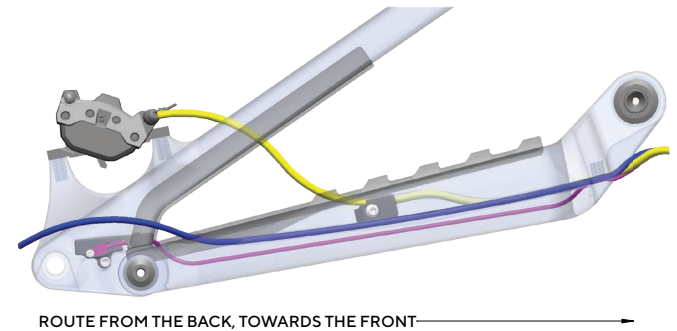

FASTEN THE BRAKE CALIPER, REAR DERAILLEUR AND SPEED SENSOR IN POSITION AND THEN START ROUTING FROM THE BACK OF THE BIKE AND WORK FORWARDS.



CABLE ROUTING

DETAILED VIEW CONTINUED

KEY

-  A - DISPLAY CABLE
-  B - DROPPER POST CABLE
-  C - REAR DERAILLEUR CABLE
-  D - BRAKE HOSE
-  E - SPEED SENSOR CABLE

3.4: THE CHAINSTAY PROTECTOR WILL NEED TO BE PERFORATED USING A PICK. THE DERAILLEUR CABLE HOUSING OR AXS EXTENSION CORD CAN THEN BE PUSHED THROUGH THE OPENING.



PERFORATE

AXS EXTENSION CORD



DERAILLEUR HOUSING

3.5: THE CABLES AND BRAKE HOSE WILL EXIT THE CHAINSTAY PORTS NEAR THE MAIN PIVOT FROM HERE THEY NEED TO PASS INTO THE FRONT TRIANGLE THROUGH THE PORT AT THE BOTTOM OF THE SEAT TUBE.

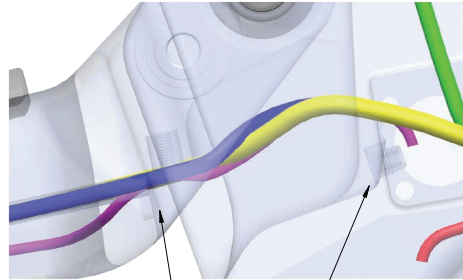

CHAINSTAY CABLE PORTS

FRONT TRIANGLE CABLE PORT

3.6: ARRANGE THE CABLES AND BRAKE HOSE AS SHOWN IN THE ILLUSTRATIONS BELOW. RE-INSTALL THE CABLE PORT CLAMPS.

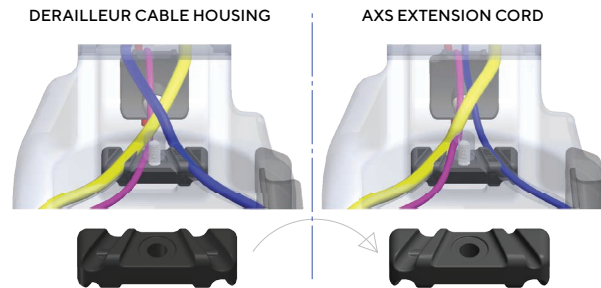

THE CHAINSTAY CABLE PORT CLAMP IS BI-DIRECTIONAL. FLIP IT ALONG ITS LENGTH TO SUIT THE CABLE HOUSING OR AXS EXTENSION CORD.

3.7:

WITH THE REAR SUSPENSION AT FULL COMPRESSION (BOTTOMED OUT), CLAMP THE CABLES AND HOSE IN PLACE [1-2Nm]. BE CAREFUL NOT TO PINCH ANY OF THE CABLES OR OVERTIGHTEN AND PINCH THE INNER CABLE.

ONCE CLAMPED, THE SUSPENSION CAN BE CYCLED TO FULL EXTENSION AND RE-INSTALL THE SHOCK.

3.8:

DERAILLEUR CABLE HOUSING AND BRAKE HOSE ARE ROUTED ALONG THE TOP OF THE DOWNTUBE AND UP TOWARDS THE HEAD TUBE. USE THE DISPLAY PORT IN THE TOP TUBE TO HELP GUIDE THE CABLE/HOSE THROUGH THE HEAD TUBE CABLE PORTS.

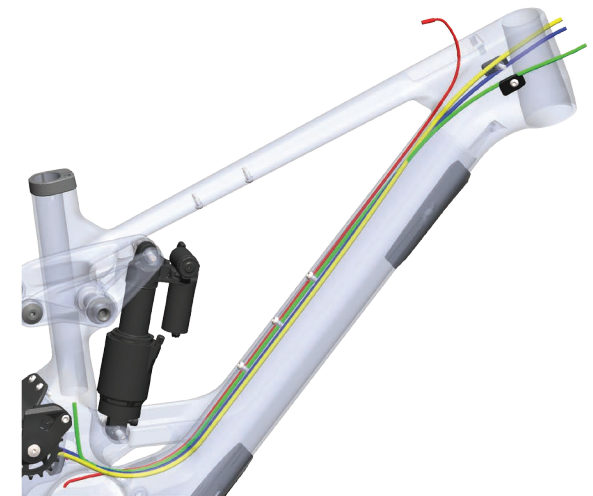

BATTERY & MOTOR INSTALLATION

STEP 1: 600Wh OR 800Wh BATTERY

1.1:
SLIDE THE BATTERY INTO THE DOWN TUBE FROM THE BOTTOM.

1.2:
SECURE THE BATTERY USING THE UPPER AND LOWER BOLTS TO THE SPECIFIED TORQUE. NOTE, FOR THE 800Wh BATTERY, THE TOP BOLT IS INSTALLED VIA THE TOP TUBE MOUNTING HOLE FOR THE DISPLAY SCREEN.

SEE VIEWS ON PAGE 9 FOR REFERENCE.

STEP 2: DISPLAY SCREEN

A SIM CARD IS NOT INCLUDED WITH THE E-BIKE. REFER TO THE PRODUCT MANUFACTURER'S LITERATURE FOR INSTALLATION DETAILS, IF NEEDED.

2.1:
PLUG THE DISPLAY CABLE (CABLE A) TO THE DISPLAY SCREEN CABLE PORT.

2.2:
INSTALL THE DISPLAY SCREEN TO THE TOP TUBE MOUNTING HOLE AND SECURE USING MOUNTING BOLTS TO THE SPECIFIED TORQUE.

SEE VIEWS ON PAGE 9 FOR REFERENCE.

STEP 3: MULTIPOINT CABLE CHARGER PORT AND BATTERY CONNECTOR

3.1:
ENSURE THE CHARGER PORT'S CABLES ARE ORIENTED UPWARDS AND LOOPED BEHIND PRIOR TO INSTALLATION.

3.2:
PLACE THE DOOR SEAL OVER THE FACE OF THE CHARGER PORT. WITH THE CHARGER PORT IN PLACE, INSTALL AND SECURE THE CHARGER PORT COVER ASSEMBLY TO THE SEAT TUBE MOUNTING HOLE TO THE SPECIFIED TORQUE.

3.3:
CONNECT THE MULTIPOINT CABLE'S BATTERY CONNECTOR TO THE BATTERY PORT.

SEE VIEWS ON PAGE 9 FOR REFERENCE.

STEP 4: MOTOR AND COVER

4.1:
PRIOR TO SECURING THE MOTOR TO THE FRAME, CONNECT THE MOTOR CABLES TO THE DISPLAY SCREEN (CABLE A), SPEED SENSOR (CABLE E) AND MULTIPOINT CABLE POWER CONNECTOR (CABLE F).

4.2:
ALIGN THE MOTOR WITH THE FRAME AND SECURE WITH MOUNTING HARDWARE TO THE SPECIFIED TORQUE.

4.3:
INSERT THE FRONT PART OF THE MOTOR COVER TO THE DOWN TUBE OF THE FRAME. ALIGN THE MIDDLE PART OF THE MOTOR COVER WITH THE MOTOR HEAT SINK AND PRESS DOWN FIRMLY.

4.4:
TO SECURE THE MOTOR COVER, FIRST INSTALL THE TWO FRONT BOLTS WITHOUT TIGHTENING THEM; AND THEN INSTALL THE BACK BOLT WITHOUT TIGHTENING IT. TIGHTEN THE BOLTS SEQUENTIALLY FROM FRONT TO BACK TO THE SPECIFIED TORQUE.

SEE VIEWS ON PAGES 5 & 10 FOR REFERENCE.

BATTERY & MOTOR INSTALLATION

CONTINUED

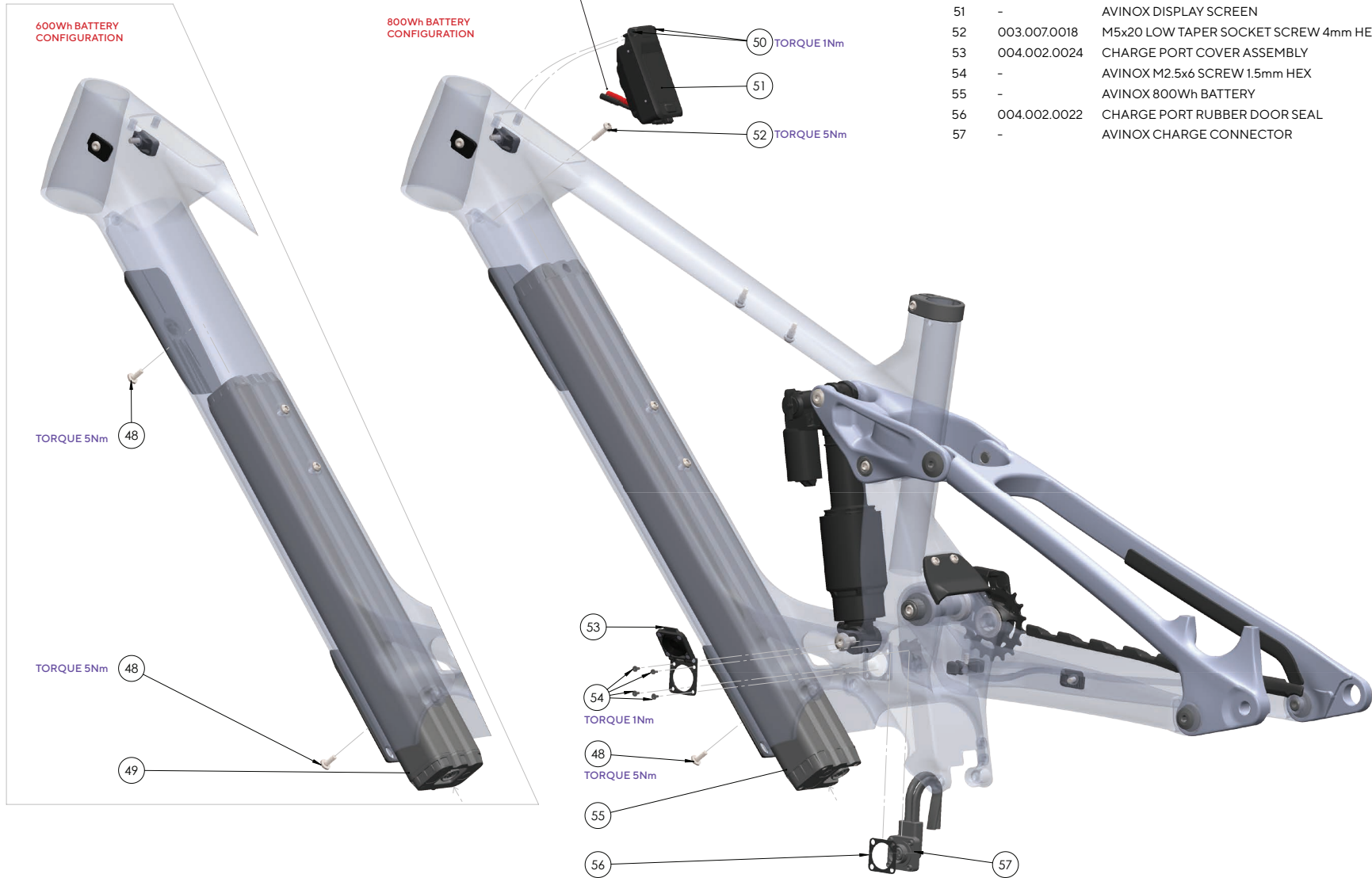

ITEM NO.	PART NO.	DESCRIPTION	QTY
48	003.007.0021	M5x13 WIDE HEAD SOCKET SCREW 4mm HEX	1 or 2
49	-	AVINOX 600Wh BATTERY	1
50	-	AVINOX M3 DISPLAY SCREEN SCREW 2mm HEX	2
51	-	AVINOX DISPLAY SCREEN	1
52	003.007.0018	M5x20 LOW TAPER SOCKET SCREW 4mm HEX	1
53	004.002.0024	CHARGE PORT COVER ASSEMBLY	1
54	-	AVINOX M2.5x6 SCREW 1.5mm HEX	4
55	-	AVINOX 800Wh BATTERY	1
56	004.002.0022	CHARGE PORT RUBBER DOOR SEAL	1
57	-	AVINOX CHARGE CONNECTOR	1

BATTERY & MOTOR INSTALLATION

CONTINUED

ITEM NO.	PART NO.	DESCRIPTION	QTY
58	-	AVINOX DRIVE UNIT, M2 OR M2S	1
59	-	AVINOX MOUNTING BOLT [LONG] 6mm HEX	1
60	-	AVINOX M8x1.25 NUT 8mm HEX	2
61	-	AVINOX MOUNTING BOLT [SHORT] 6mm HEX	1
62	-	AVINOX LOCKING WASHER	4
63	004.002.0028	DRUID E & DREADNOUGHT E, MOTOR COVER, S1-S2	1
64	004.002.0029	DRUID E, MOTOR COVER, S3-S4	-
65	004.002.0038	DREADNOUGHT E, MOTOR COVER, S3-S4	-
66	003.007.0023	M4x10 LOW TAPER SOCKET SCREW 3mm HEX	3

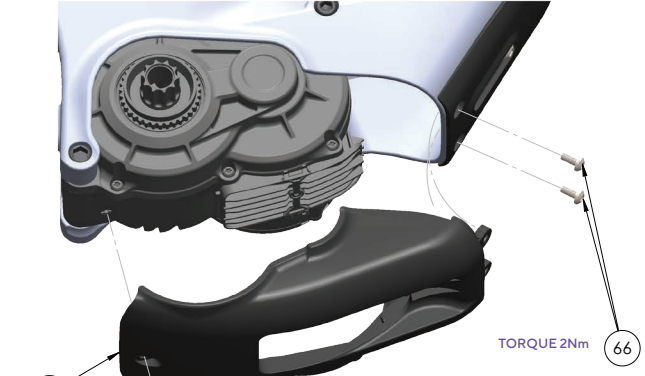
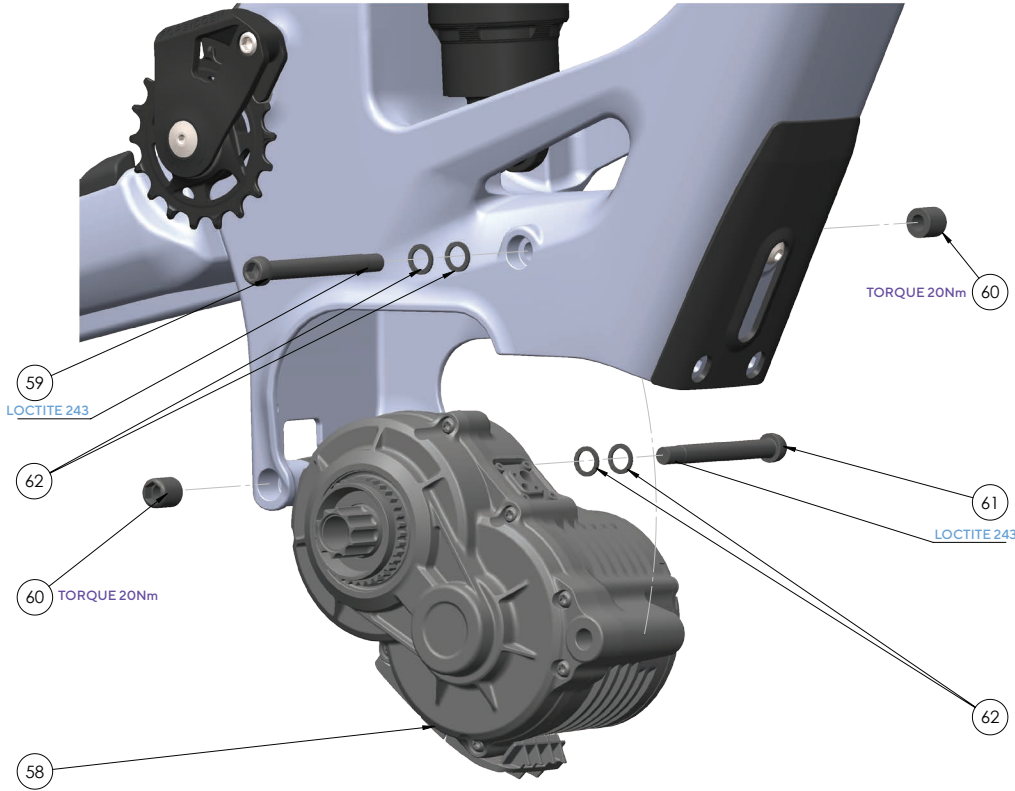

ALTERNATIVE MOTOR COVERS USED ON:

IDENTIFYING EACH MOTOR COVER:

- VLD-II-1813**
= DRUID E & DREADNOUGHT E, S1 - S2
- VLD-II-1814**
= DRUID E, S3 - S4
- VLD-CI-1903**
= DREADNOUGHT E, S3 - S4

CRANK & SPIDER INSTALLATION

ITEM NO.	PART NO.	DESCRIPTION	QTY
67	-	CHAINRING	1
68	-	CRANKS	2
69	-	CHAINRING BOLTS	4
70	-	CHAINRING NUTS	4
71	-	CHAINRING SPIDER 104 BCD	1
72	-	SPIDER LOCKING RING	1

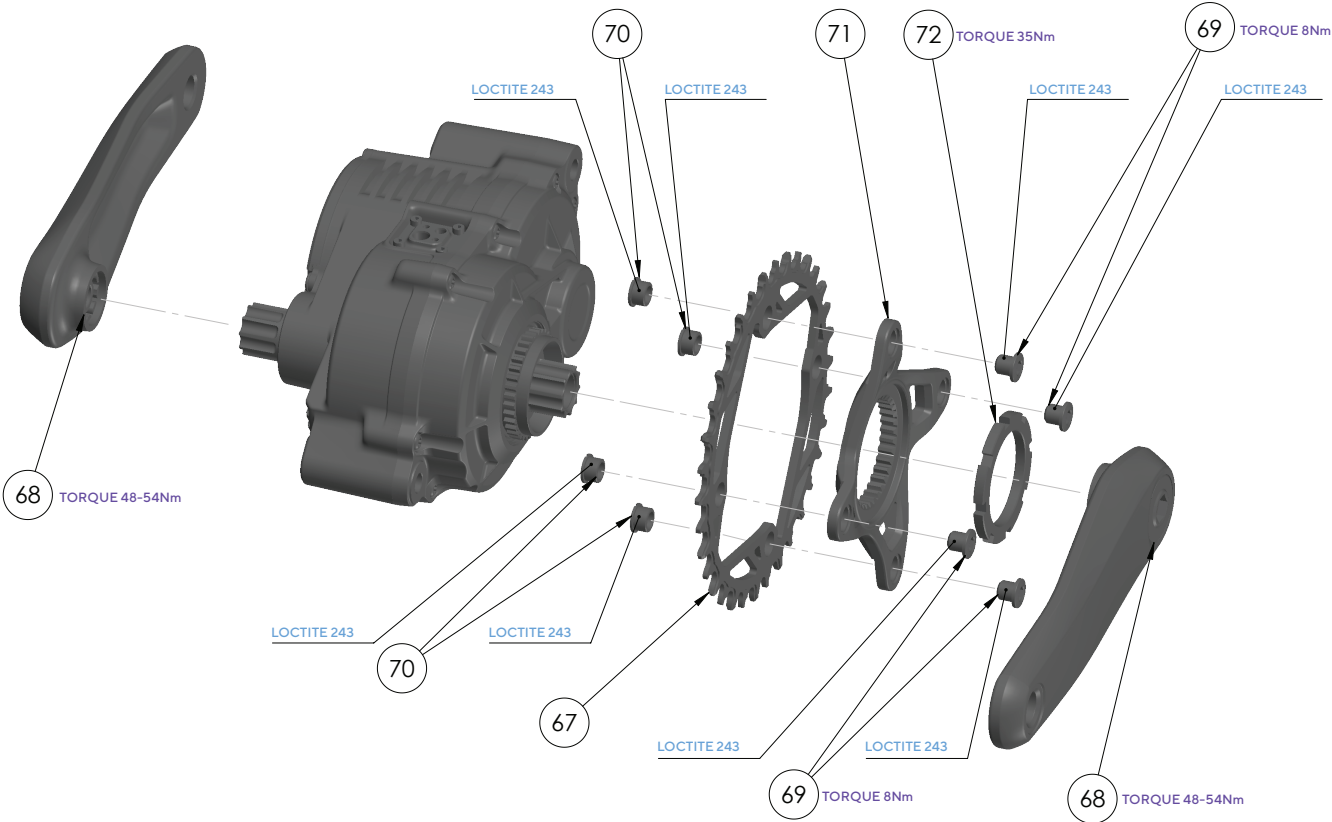

ASSEMBLY & SETUP

UNIVERSAL DERAILLEUR HANGER (UDH)

The universal derailleur hanger (UDH) is mounted on the rear dropout of the bike. Follow the steps below to replace it.

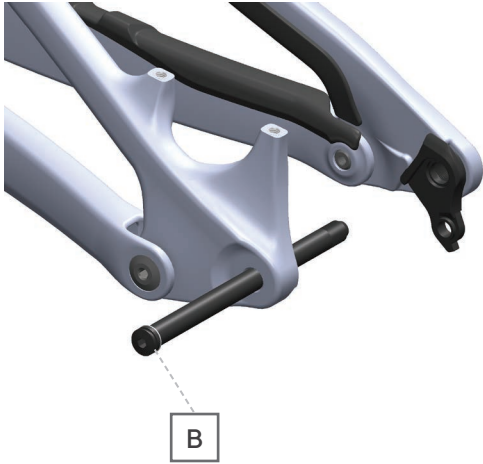

A - UDH bolt, 8mm hex, 25Nm

B - Rear Axle, 5mm hex, 12Nm

1. Remove the rear axle [B] to remove the rear wheel.
2. Remove the UDH bolt [A] and hardware, and remove the UDH. Note, the UDH bolt [A] is not shown.
3. Install the new UDH to the frame dropout and rotate it until it contacts the stop tab completely.
4. Re-install the UDH bolt [A] and hardware, then tighten to the specified torque.
5. Mount the rear wheel and re-install the rear axle [B], tightening the axle to the specified torque.

SPEED SENSOR RING

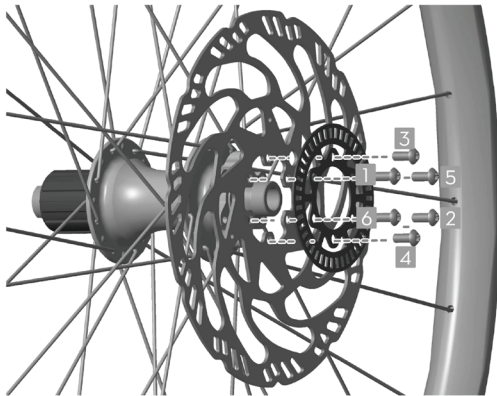

The speed sensor ring is mounted on the rear brake rotor. Ensure to remove and re-install the speed sensor ring when replacing the rear wheel or rear brake rotor. Tighten the bolts in the following order, see illustration for reference,

1 -> 2 -> 3 -> 4 -> 5 -> 6 - Rotor Bolts, T25, 5Nm

ASSEMBLY & SETUP

SEATPOST INSERTION & ADJUSTMENT

The saddle height can be set by adjusting the seatpost. However, each frame and seatpost has specific minimum and maximum insertion depth requirements for safety. If you don't have the necessary skills to determine your saddle height and/or adjust your seatpost, please refer to your local bike shop or authorized Forbidden dealer for professional help from a qualified person.

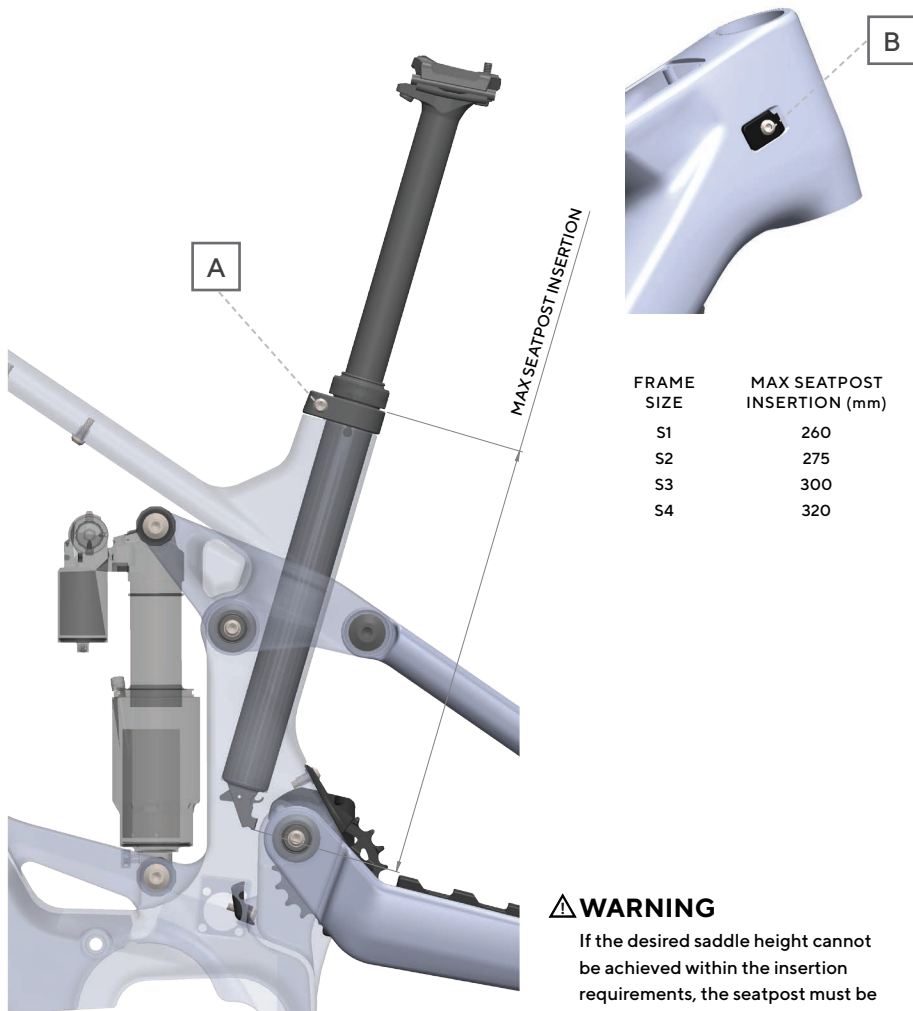

FRAME SIZE	MAX SEATPOST INSERTION (mm)
S1	260
S2	275
S3	300
S4	320

⚠ WARNING

If the desired saddle height cannot be achieved within the insertion requirements, the seatpost must be replaced with a different length.

A - Seat Clamp Screw, 5mm hex, 6Nm
B - Cable Port Screw, 4mm hex, 2Nm

1. The seatpost must not be inserted past the frame's maximum insertion depth.
2. Check the minimum insertion depth of the seatpost, which is physically marked on the seatpost. The seatpost must be inserted into the frame such that the minimum insertion mark is not visible.
3. Loosen the seat clamp screw [A].
4. Loosen the cable port screw [B] so the cable housing for the dropper is free to move in the cable port.
5. If the seatpost needs to be lifted, feed the cable housing into the frame. If the seatpost needs to be lowered, pull the excess cable out from the frame.
6. Check the insertion requirements are satisfied at the adjusted height. If the desired saddle height cannot be achieved within the insertion requirements, the seatpost must be replaced with a different length.
7. Once the adjustment is complete, tighten the seat clamp screw [A] to the specified torque.
8. Pull tight on the cable housing at the headtube to remove any slack from inside the frame, which should stop the cable from rattling while riding.
9. Tighten the cable port screw [B] to the specified torque.

If a change is required to the dropper cable housing, refer to the cable routing section of this manual.